

## MOBILE HOMES - PRICE-LIST FOR INDIVIDUAL GUESTS IN € - 2011

Services	Seasons	01.05-11.06 10.09-30.09	03.09-10.09	11.06-25.06	25.06-02.07 27.08-03.09	02.07-09.07 20.08-27.08	09.07-20.08
	Season 1	Season 2	Season 3	Season 4	Season 5	Season 6	
MOBILE HOME <i>Shelbox-Quarzo</i>		44	68	84	99	124	156
MOBILE HOME <i>SunRoller-Dalmacija</i>		48	72	88	104	129	162
MOBILE HOME <i>Shelbox-Tavolara</i>		48	72	88	104	129	162
Stay up to 3 days		/	/	/	/	+20%	+20%
Baby cot < 3 years		6	6	6	6	6	6
Pet		10	10	10	10	10	10
Half-board (B+D): - adult		19	19	19	21	21	21
- child 0-2,99 y.		incl.	incl.	incl.	incl.	incl.	incl.
- child 3-11,99 y.		incl.	incl.	Incl.	50%	50%	50%
Minimum stay in days	01.05-09.07 und 03.09 -30.09 = 3 days, 09.07-03.09 = 7 days						
Arrival-departure (check in-16:00, check out-09:00)	01.05-09.07 and 03.09 -30.09 = every day, 09.07-03.09 = Saturday-Saturday						

- Tourist tax: is not included in the prices and is paid 1 € per person/day. Persons from 12 - 17 years pay 50% and children under 12 are free of charge.
- Rental of mobile homes includes: bed linen (exchange every 7 days), electricity, water, gas, towels (exchange twice a week), cooking utensils and cutlery.
- Down-payment: a reservation is confirmed after the down payment of € 250 has been made. The amount will be returned if the reservation is canceled 21 days before the guests' arrival date. For all reservations that have been canceled 21 days before the guests' arrival, the down payment will not be returned.
- Registration fee: € 1 - paid once, per a person.
- Deposit: € 100 is paid upon arrival.
- Final cleaning: is not included in the rental price. Guests need to leave the mobile home clean, otherwise € 35 will be deducted from the deposit.
- Pets: allowed.
- All mobile homes are equipped with: air-conditioning, refrigerator, gas cooker with 4 rings, microwave oven, coffee machine, SAT TV and outdoor furniture.

Shelbox - Quarzo

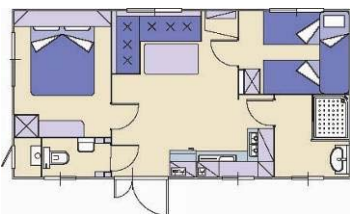

- Number of persons: 5 + 1
- Area size: 7,50 × 3,80 m = 28,50 m<sup>2</sup>
- Equipped with: bedroom (bed size 140×200 cm), bedroom (2 beds sized 70×190 cm + bunk bed), living / dining room (bed size 70×190 cm), kitchen corner, shower cabin, separate toilet.
- Electricity: 16 A
- Covered patio: 4 × 2,40 m = 9,60 m<sup>2</sup>

Sun Roller - Evasion Dalmacija

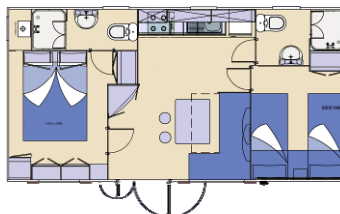

- Number of persons: 5 + 1
- Area size: 7,70 × 4 m = 30,80 m<sup>2</sup>
- Equipped with: bedroom (bed size 140×200 cm), bedroom (2 beds sized 80×190 cm + bunk bed), living / dining room (bed size 70×190 cm), kitchen corner, 2 x shower cabin / toilet.
- Electricity: 16 A
- Covered patio: 4 × 2,50 m = 10 m<sup>2</sup>

Shelbox - Tavolara

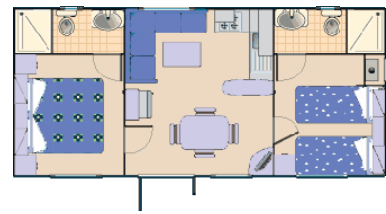

- Number of persons: 4 + 1
- Area size: 8 × 4 m = 32 m<sup>2</sup>
- Equipped with: bedroom (bed size 140×200 cm), bedroom (2 beds sized 80×190 cm), living / dining room (bed size 70×190 cm), kitchen corner, 2 x shower cabin / toilet.
- Electricity: 16 A
- Covered patio: 4 × 2,50 m = 10 m<sup>2</sup>

Zaton Holiday Resort - Camp